

# teletronik®

## Drop cables



**teletronik® AG** 

Vorstadt 32  
CH, 6304 Zug  
Switzerland

[teletronik@teletronik.com](mailto:teletronik@teletronik.com)  
[www.teletronik.com](http://www.teletronik.com)

**Brief Introduction**

Teletronik RG series coaxial cable was developed to meet the increasing demand of tomorrow's broadband networks. RG series cable has the highest reliability and flexibility of any coaxial cable, low RF attenuation and an unprecedented 10 year warranty. RG series is optimized for use in broadband feeder plants. It offers lower attenuation than other traditional products, with unmatched flexibility, reliability and cost effectiveness.

**Explanation of codes**

**RG6-S60-F**

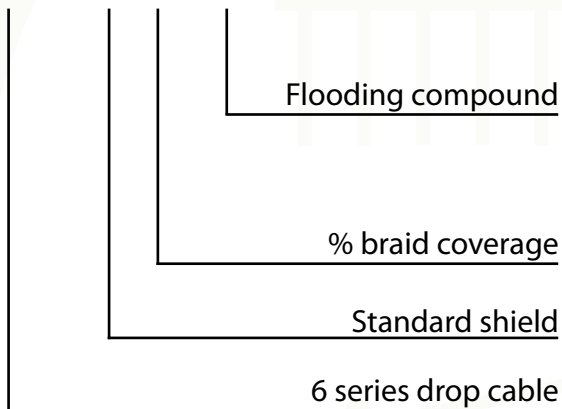

**RG11-T60-M-CCS**

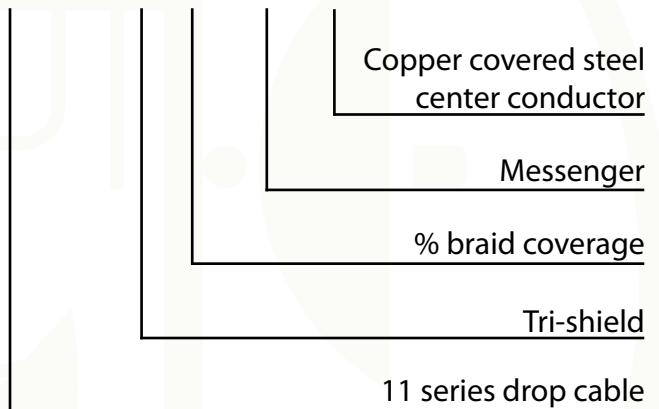

**Braid coverage description**

$$\text{Percent of coverage} = (2F - 2 F^2) \times 100$$

Where:  $F = \text{NPd} / \text{Sin } A$

$A = \text{Tan}^{-1} 2 \pi (D + 2d) (P/C)$

- And:
- C = Number of carriers (groups of ends)
  - N = Number of ends (strands) per carrier
  - P = Picks per inch (carrier crossing points)
  - d = Diameter of individual wire strand (mm)
  - D = Diameter of structure under the braid (mm)

**Suffix**

- S = standard
- T = tri-shield
- Q = quad shield
- F = flooding compound
- M = messenger
- H = home cable
- CCS = copper cut steel inner conductor

**RG59-T60-HCU**  
coax cable



**Tri-shield construction**

- 20 gauge (0,81 mm) copper center conductor
- Foamed PE, bounded foil, 60% braid, non-bounded tape, PVC jacket
- Gas expanded polyethylene dielectric
- Aluminium-polypropylene-aluminium laminated tape inner shield with overlap bounded to dielectric
- 34 AWG bare aluminium braid wire outer shield
- White polyvinylchloride jacket

**Electrical characteristics**

Nominal impedance	75 Ω
Nominal velocity of propagation	85 %
Shielding effectiveness	> 100 dB

**Physical Dimensions**

component	∅ (mm)
Nominal center conductor diameter	0,81
Nominal diameter over dielectric	3,66
Nominal diameter over first shield (tape)	3,84
Nominal diameter over jacket	6,10
Nominal jacket wall thickness	0,76

**Attenuation (@ 20°C)**

frequency (MHz)	max. loss (dB/100m)
5	2,82
55	6,73
83	8,04
187	11,81
211	12,47
250	13,45
300	14,60
350	15,75
400	16,73
450	17,72
500	18,70
550	19,52
600	20,34
750	22,87
865	24,67
1000	26,64

**Reel parameters**

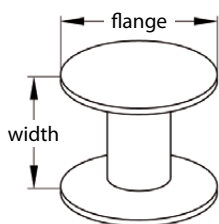

width: 215 mm  
 flange: 330 mm  
 weight: 11 kg  
 cable length: 305 m

**RG6-S60-CCS**  
coax cable



**Standard construction**

- 18 gauge (1,02 mm) copper covered steel center conductor
- Foamed PE, bounded foil, 60% braid, PVC jacket
- Gas expanded polyethylene dielectric
- Aluminium-polypropylene-aluminium laminated tape inner shield with overlap bounded to dielectric
- 34 AWG bare aluminium braid wire outer shield
- Black polyvinylchloride jacket

**Electrical characteristics**

Nominal impedance	75 Ω
Nominal velocity of propagation	85 %
Shielding effectiveness	> 100 dB

**Physical Dimensions**

component	∅ (mm)
Nominal center conductor diameter	1,02
Nominal diameter over dielectric	4,57
Nominal diameter over first shield (tape)	4,75
Nominal diameter over jacket	6,91
Nominal jacket wall thickness	0,76

**Attenuation (@ 20°C)**

frequency (MHz)	max. loss (dB/100m)
5	1,90
55	5,25
83	6,40
187	9,35
211	10,00
250	10,82
300	11,64
350	12,63
400	13,61
450	14,43
500	15,09
550	16,08
600	16,73
750	18,54
865	20,01
1000	21,49

**Reel parameters**

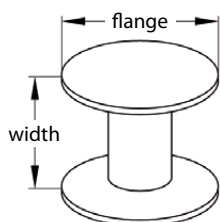

width: 215 mm  
 flange: 360 mm  
 weight: 12,5 kg  
 cable length: 305 m

**RG6-S60-M**  
coax cable



**Standard, messengered construction**

- 18 gauge (1,02 mm) copper center conductor
- Foamed PE, bounded foil, 60% braid, PVC jacket
- Gas expanded polyethylene dielectric
- Aluminium-polypropylene-aluminium laminated tape inner shield with overlap bounded to dielectric
- 34 AWG bare aluminium braid wire outer shield
- Black polyvinylchloride jacket
- Minimum breaking strength of messenger 82 kg, @1,30 mm

**Electrical characteristics**

Nominal impedance	75 Ω
Nominal velocity of propagation	85 %
Shielding effectiveness	> 100 dB

**Physical Dimensions**

component	Ø (mm)
Nominal center conductor diameter	1,02
Nominal diameter over dielectric	4,57
Nominal diameter over first shield (tape)	4,75
Nominal diameter over jacket	6,91
Nominal jacket wall thickness	0,76
Nominal diameter of steel messenger	1,30

**Attenuation (@ 20°C)**

frequency (MHz)	max. loss (dB/100m)
5	1,90
55	5,25
83	6,40
187	9,35
211	10,00
250	10,82
300	11,64
350	12,63
400	13,61
450	14,43
500	15,09
550	16,08
600	16,73
750	18,54
865	20,01
1000	21,49

**Reel parameters**

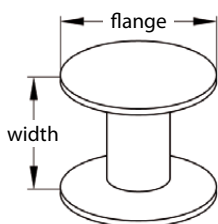

width: 205 mm  
 flange: 420 mm  
 weight: 22 kg  
 cable length: 305 m

**RG6-T60-HCU-E**  
coax cable



**Tri-shield construction**

- 18 gauge (1,02 mm) copper center conductor
- Foamed PE, bounded foil, 60% braid, non-bonded tape, PVC jacket
- Gas expanded polyethylene dielectric
- Aluminium-polypropylene-aluminium laminated tape inner shield with overlap bounded to dielectric
- 34 AWG bare aluminium braid wire outer shield
- Black polyvinylchloride jacket

**Electrical characteristics**

Nominal impedance	75 Ω
Nominal velocity of propagation	85 %
Shielding effectiveness	> 100 dB

**Physical Dimensions**

component	∅ (mm)
Nominal center conductor diameter	1,02
Nominal diameter over dielectric	4,57
Nominal diameter over first shield (tape)	4,75
Nominal diameter over jacket	7,06
Nominal jacket wall thickness	0,76

**Attenuation (@ 20°C)**

frequency (MHz)	max. loss (dB/100m)
5	1,90
55	5,25
83	6,40
187	9,35
211	10,00
250	10,82
300	11,64
350	12,63
400	13,61
450	14,43
500	15,09
550	16,08
600	16,73
750	18,54
865	20,01
1000	21,49

**Reel parameters**

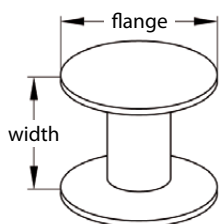

width: 270 mm  
 flange: 280 mm  
 weight: 12,5 kg  
 cable length: 305 m  
 (2 reels / package)

**RG6-T60-HCU-E**  
coax cable



**Tri-shield construction**

- 18 gauge (1,02 mm) copper center conductor
- Foamed PE, bounded foil, 60% braid, non-bonded tape, PVC jacket
- Gas expanded polyethylene dielectric
- Aluminium-polypropylene-aluminium laminated tape inner shield with overlap bounded to dielectric
- 34 AWG bare aluminium braid wire outer shield
- White polyvinylchloride jacket

**Electrical characteristics**

Nominal impedance	75 Ω
Nominal velocity of propagation	85 %
Shielding effectiveness	> 100 dB

**Physical Dimensions**

component	Ø (mm)
Nominal center conductor diameter	1,02
Nominal diameter over dielectric	4,57
Nominal diameter over first shield (tape)	4,75
Nominal diameter over jacket	7,06
Nominal jacket wall thickness	0,76

**Attenuation (@ 20°C)**

frequency (MHz)	max. loss (dB/100m)
5	1,90
55	5,25
83	6,40
187	9,35
211	10,00
250	10,82
300	11,64
350	12,63
400	13,61
450	14,43
500	15,09
550	16,08
600	16,73
750	18,54
865	20,01
1000	21,49

**Reel parameters**

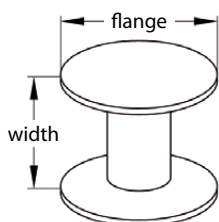

width: 270 mm  
 flange: 280 mm  
 weight: 12,5 kg  
 cable length: 305 m  
 (2 reels / package)

**RG6-T60-CCS**  
coax cable



**Tri-shield construction**

- 18 gauge (1,02 mm) copper covered steel center conductor
- Foamed PE, bounded foil, 60% braid, non-bonded tape, PVC jacket
- Gas expanded polyethylene dielectric
- Aluminium-polypropylene-aluminium laminated tape inner shield with overlap bounded to dielectric
- 34 AWG bare aluminium braid wire outer shield
- White polyvinylchloride jacket

**Electrical characteristics**

Nominal impedance	75 Ω
Nominal velocity of propagation	85 %
Shielding effectiveness	> 100 dB

**Physical Dimensions**

component	∅ (mm)
Nominal center conductor diameter	1,02
Nominal diameter over dielectric	4,57
Nominal diameter over first shield (tape)	4,75
Nominal diameter over jacket	7,06
Nominal jacket wall thickness	0,76

**Attenuation (@ 20°C)**

frequency (MHz)	max. loss (dB/100m)
5	1,90
55	5,25
83	6,40
187	9,35
211	10,00
250	10,82
300	11,64
350	12,63
400	13,61
450	14,43
500	15,09
550	16,08
600	16,73
750	18,54
865	20,01
1000	21,49

**Reel parameters**

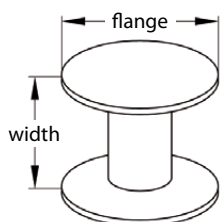

width: 260 mm  
 flange: 310 mm  
 weight: 15 kg  
 cable length: 305 m



**RG6-T60-F-CCS**  
coax cable



**Tri-shield, flooded construction**

- 18 gauge (1,02 mm) copper covered steel center conductor
- Foamed PE, bounded foil, 60% braid, non-bonded tape, flooded for underground, PE jacket
- Gas expanded polyethylene dielectric
- Aluminium-polypropylene-aluminium laminated tape inner shield with overlap bounded to dielectric
- 34 AWG bare aluminium braid wire outer shield
- Black polyethylene jacket

**Electrical characteristics**

Nominal impedance	75 Ω
Nominal velocity of propagation	85 %
Shielding effectiveness	> 100 dB

**Physical Dimensions**

component	Ø (mm)
Nominal center conductor diameter	1,02
Nominal diameter over dielectric	4,57
Nominal diameter over first shield (tape)	4,75
Nominal diameter over jacket	7,06
Nominal jacket wall thickness	0,76

**Attenuation (@ 20°C)**

frequency (MHz)	max. loss (dB/100m)
5	1,90
55	5,25
83	6,40
187	9,35
211	10,00
250	10,82
300	11,64
350	12,63
400	13,61
450	14,43
500	15,09
550	16,08
600	16,73
750	18,54
865	20,01
1000	21,49

**Reel parameters**

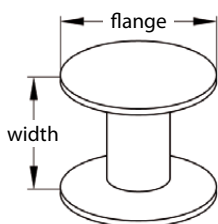

width: 270 mm  
 flange: 330 mm  
 weight: 13 kg  
 cable length: 305 m

**RG6-T60-M**  
coax cable



**Tri-shield, messengered construction**

- 18 gauge (1,02 mm) copper center conductor
- Foamed PE, bounded foil, 60% braid, non-bonded tape, PVC jacket, steel messenger
- Gas expanded polyethylene dielectric
- Aluminium-polypropylene-aluminium laminated tape inner shield with overlap bounded to dielectric
- 34 AWG bare aluminium braid wire outer shield
- Black polyvinylchloride jacket
- Minimum breaking strength of messenger 82 kg<sub>f</sub> @1,30 mm

**Electrical characteristics**

Nominal impedance	75 Ω
Nominal velocity of propagation	85 %
Shielding effectiveness	> 100 dB

**Physical Dimensions**

component	∅ (mm)
Nominal center conductor diameter	1,02
Nominal diameter over dielectric	4,57
Nominal diameter over first shield (tape)	4,75
Nominal diameter over jacket	7,06
Nominal jacket wall thickness	0,76
Nominal diameter of steel messenger	1,30

**Attenuation (@ 20°C)**

frequency (MHz)	max. loss (dB/100m)
5	1,90
55	5,25
83	6,40
187	9,35
211	10,00
250	10,82
300	11,64
350	12,63
400	13,61
450	14,43
500	15,09
550	16,08
600	16,73
750	18,54
865	20,01
1000	21,49

**Reel parameters**

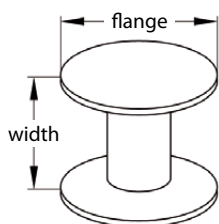

width: 200 mm  
 flange: 430 mm  
 weight: 22 kg  
 cable length: 305 m

**RG6-T60-M-CCS**  
coax cable

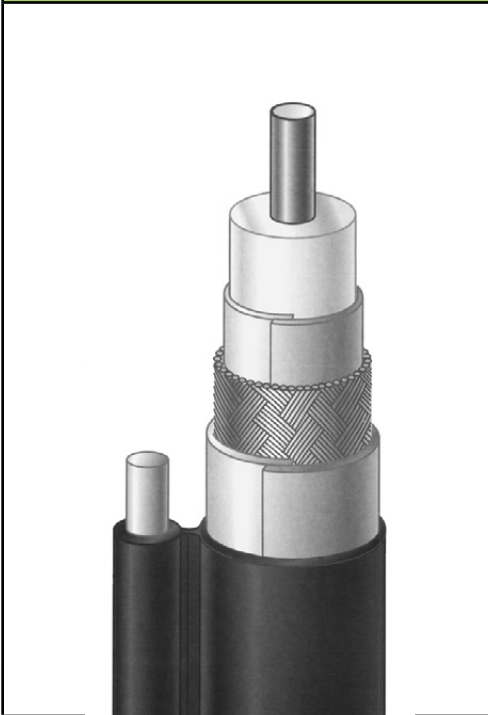

**Tri-shield, messengered construction**

- 18 gauge (1,02 mm) copper covered steel center conductor
- Foamed PE, bounded foil, 60% braid, non-bonded tape, PVC jacket, steel messenger
- Gas expanded polyethylene dielectric
- Aluminium-polypropylene-aluminium laminated tape inner shield with overlap bounded to dielectric
- 34 AWG bare aluminium braid wire outer shield
- Black polyvinylchloride jacket
- Minimum breaking strength of messenger 82 kg<sub>f</sub> @1,30 mm

**Electrical characteristics**

Nominal impedance	75 Ω
Nominal velocity of propagation	85 %
Shielding effectiveness	> 100 dB

**Physical Dimensions**

component	∅ (mm)
Nominal center conductor diameter	1,02
Nominal diameter over dielectric	4,57
Nominal diameter over first shield (tape)	4,75
Nominal diameter over jacket	7,06
Nominal jacket wall thickness	0,76
Nominal diameter of steel messenger	1,30

**Attenuation (@ 20°C)**

frequency (MHz)	max. loss (dB/100m)
5	1,90
55	5,25
83	6,40
187	9,35
211	10,00
250	10,82
300	11,64
350	12,63
400	13,61
450	14,43
500	15,09
550	16,08
600	16,73
750	18,54
865	20,01
1000	21,49

**Reel parameters**

	width: 295 mm
	flange: 340 mm
	weight: 21 kg
	cable length: 305 m

**RG6-Q60**  
coax cable



**Quad-shield construction**

- 18 gauge (1,02 mm) copper center conductor
- Foamed PE, bounded foil, 60% braid, non-bounded tape, 32% braid, PVC jacket
- Gas expanded polyethylene dielectric
- Aluminium-polypropylene-aluminium laminated tape inner shield with overlap bounded to dielectric
- 34 AWG bare aluminium braid wire outer shield
- White polyvinylchloride jacket

**Electrical characteristics**

Nominal impedance	75 Ω
Nominal velocity of propagation	85 %
Shielding effectiveness	> 100 dB

**Physical Dimensions**

component	∅ (mm)
Nominal center conductor diameter	1,02
Nominal diameter over dielectric	4,57
Nominal diameter over first shield (tape)	4,75
Nominal diameter over jacket	7,62
Nominal jacket wall thickness	0,86

**Attenuation (@ 20°C)**

frequency (MHz)	max. loss (dB/100m)
5	1,90
55	5,25
83	6,40
187	9,35
211	10,00
250	10,82
300	11,64
350	12,63
400	13,61
450	14,43
500	15,09
550	16,08
600	16,73
750	18,54
865	20,01
1000	21,49

**Reel parameters**

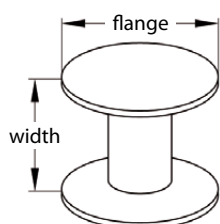

width: 245 mm  
 flange: 330 mm  
 weight: 12 kg  
 cable length: 200 m

**RG11-S60-CCS**  
coax cable



**Standard construction**

- 14 gauge (1,63 mm) copper covered steel center conductor
- Foamed PE, bounded foil, 60% braid, PVC jacket
- Gas expanded polyethylene dielectric
- Aluminium-polypropylene-aluminium laminated tape inner shield with overlap bounded to dielectric
- 34 AWG bare aluminium braid wire outer shield
- Black polyvinylchloride jacket

**Electrical characteristics**

Nominal impedance	75 Ω
Nominal velocity of propagation	85 %
Shielding effectiveness	> 100 dB

**Physical Dimensions**

component	Ø (mm)
Nominal center conductor diameter	1,63
Nominal diameter over dielectric	7,11
Nominal diameter over first shield (tape)	7,29
Nominal diameter over jacket	10,03
Nominal jacket wall thickness	1,07

**Attenuation (@ 20°C)**

frequency (MHz)	max. loss (dB/100m)
5	1,25
55	3,15
83	3,87
187	5,74
211	6,23
250	6,72
300	7,38
350	7,94
400	8,53
450	9,02
500	9,51
550	9,97
600	10,43
750	11,97
865	13,05
1000	14,27

**Reel parameters**

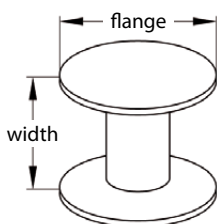

width: 360 mm  
 flange: 395 mm  
 weight: 24 kg  
 cable length: 305 m

**RG11-S60-M**  
coax cable



**Standard, messengered construction**

- 14 gauge (1,63 mm) copper center conductor
- Foamed PE, bounded foil, 60% braid, PVC jacket, steel messenger
- Gas expanded polyethylene dielectric
- Aluminium-polypropylene-aluminium laminated tape inner shield with overlap bounded to dielectric
- 34 AWG bare aluminium braid wire outer shield
- Black polyvinylchloride jacket
- Minimum breaking strength of messenger 166 kg, @1,83 mm

**Electrical characteristics**

Nominal impedance	75 Ω
Nominal velocity of propagation	85 %
Shielding effectiveness	> 100 dB

**Physical Dimensions**

component	∅ (mm)
Nominal center conductor diameter	1,63
Nominal diameter over dielectric	7,11
Nominal diameter over first shield (tape)	7,29
Nominal diameter over jacket	10,03
Nominal jacket wall thickness	1,07
Nominal diameter of steel messenger	1,83

**Attenuation (@ 20°C)**

frequency (MHz)	max. loss (dB/100m)
5	1,25
55	3,15
83	3,87
187	5,74
211	6,23
250	6,72
300	7,38
350	7,94
400	8,53
450	9,02
500	9,51
550	9,97
600	10,43
750	11,97
865	13,05
1000	14,27

**Reel parameters**

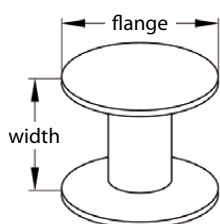

width: 350 mm  
 flange: 440 mm  
 weight: 38 kg  
 cable length: 305 m

**RG11-T60-HCU**  
coax cable



**Tri-shield construction**

- 14 gauge (1,63 mm) copper center conductor
- Foamed PE, bounded foil, 60% braid, non-bounded tape, PVC jacket
- Gas expanded polyethylene dielectric
- Aluminium-polypropylene-aluminium laminated tape inner shield with overlap bounded to dielectric
- 34 AWG bare aluminium braid wire outer shield
- White polyvinylchloride jacket

**Electrical characteristics**

Nominal impedance	75 Ω
Nominal velocity of propagation	85 %
Shielding effectiveness	> 100 dB

**Physical Dimensions**

component	Ø (mm)
Nominal center conductor diameter	1,63
Nominal diameter over dielectric	7,11
Nominal diameter over first shield (tape)	7,29
Nominal diameter over jacket	10,03
Nominal jacket wall thickness	0,99

**Attenuation (@ 20°C)**

frequency (MHz)	max. loss (dB/100m)
5	1,25
55	3,15
83	3,87
187	5,74
211	6,23
250	6,72
300	7,38
350	7,94
400	8,53
450	9,02
500	9,51
550	9,97
600	10,43
750	11,97
865	13,05
1000	14,27

**Reel parameters**

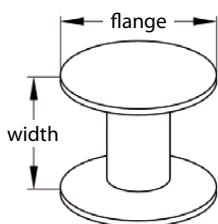

width: 360 mm  
 flange: 400 mm  
 weight: 35 kg  
 cable length: 305 m

**RG11-T60-CCS**  
coax cable



**Tri-shield construction**

- 14 gauge (1,63 mm) copper covered steel center conductor
- Foamed PE, bounded foil, 60% braid, non-bounded tape, PVC jacket
- Gas expanded polyethylene dielectric
- Aluminium-polypropylene-aluminium laminated tape inner shield with overlap bounded to dielectric
- 34 AWG bare aluminium braid wire outer shield
- Black polyvinylchloride jacket

**Electrical characteristics**

Nominal impedance	75 Ω
Nominal velocity of propagation	85 %
Shielding effectiveness	> 100 dB

**Physical Dimensions**

component	∅ (mm)
Nominal center conductor diameter	1,63
Nominal diameter over dielectric	7,11
Nominal diameter over first shield (tape)	7,29
Nominal diameter over jacket	10,03
Nominal jacket wall thickness	0,99

**Attenuation (@ 20°C)**

frequency (MHz)	max. loss (dB/100m)
5	1,25
55	3,15
83	3,87
187	5,74
211	6,23
250	6,72
300	7,38
350	7,94
400	8,53
450	9,02
500	9,51
550	9,97
600	10,43
750	11,97
865	13,05
1000	14,27

**Reel parameters**

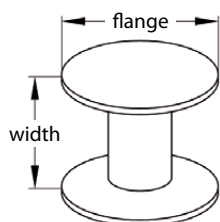

width: 365 mm  
 flange: 370 mm  
 weight: 35 kg  
 cable length: 305 m



**RG11-T60-F-CCS**  
coax cable



**Tri-shield, flooded construction**

- 14 gauge (1,63 mm) copper covered steel center conductor
- Foamed PE, bounded foil, 60% braid, non-bounded tape, flooded for underground, PE jacket
- Gas expanded polyethylene dielectric
- Aluminium-polypropylene-aluminium laminated tape inner shield with overlap bounded to dielectric
- 34 AWG bare aluminium braid wire outer shield
- Black polyethylene jacket

**Electrical characteristics**

Nominal impedance	75 Ω
Nominal velocity of propagation	85 %
Shielding effectiveness	> 100 dB

**Physical Dimensions**

component	Ø (mm)
Nominal center conductor diameter	1,63
Nominal diameter over dielectric	7,11
Nominal diameter over first shield (tape)	7,29
Nominal diameter over jacket	10,03
Nominal jacket wall thickness	0,99

**Attenuation (@ 20°C)**

frequency (MHz)	max. loss (dB/100m)
5	1,25
55	3,15
83	3,87
187	5,74
211	6,23
250	6,72
300	7,38
350	7,94
400	8,53
450	9,02
500	9,51
550	9,97
600	10,43
750	11,97
865	13,05
1000	14,27

**Reel parameters**

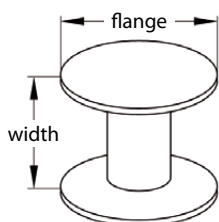

width: 355 mm  
 flange: 440 mm  
 weight: 25 kg  
 cable length: 305 m

**RG11-T60-M**  
coax cable



**Tri-shield, messengered construction**

- 14 gauge (1,63 mm) copper center conductor
- Foamed PE, bounded foil, 60% braid, non-bounded tape, PVC jacket, steel messenger
- Gas expanded polyethylene dielectric
- Aluminium-polypropylene-aluminium laminated tape inner shield with overlap bounded to dielectric
- 34 AWG bare aluminium braid wire outer shield
- Black polyvinylchloride jacket
- Minimum breaking strength of messenger 166 kg, @1,83 mm

**Electrical characteristics**

Nominal impedance	75 Ω
Nominal velocity of propagation	85 %
Shielding effectiveness	> 100 dB

**Physical Dimensions**

component	∅ (mm)
Nominal center conductor diameter	1,63
Nominal diameter over dielectric	7,11
Nominal diameter over first shield (tape)	7,29
Nominal diameter over jacket	10,03
Nominal jacket wall thickness	0,99
Nominal diameter of steel messenger	1,83

**Attenuation (@ 20°C)**

frequency (MHz)	max. loss (dB/100m)
5	1,25
55	3,15
83	3,87
187	5,74
211	6,23
250	6,72
300	7,38
350	7,94
400	8,53
450	9,02
500	9,51
550	9,97
600	10,43
750	11,97
865	13,05
1000	14,27

**Reel parameters**

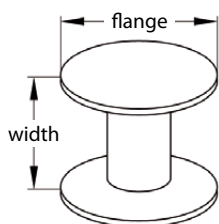

width: 350 mm  
 flange: 440 mm  
 weight: 40 kg  
 cable length: 305 m

**RG11-T60-M-CCS**  
coax cable



**Tri-shield, messengered construction**

- 14 gauge (1,63 mm) copper covered steel center conductor
- Foamed PE, bounded foil, 60% braid, non-bounded tape, PVC jacket, steel messenger
- Gas expanded polyethylene dielectric
- Aluminium-polypropylene-aluminium laminated tape inner shield with overlap bounded to dielectric
- 34 AWG bare aluminium braid wire outer shield
- Black polyvinylchloride jacket
- Minimum breaking strength of messenger 166 kg<sub>f</sub> @1,83 mm

**Electrical characteristics**

Nominal impedance	75 Ω
Nominal velocity of propagation	85 %
Shielding effectiveness	> 100 dB

**Physical Dimensions**

component	∅ (mm)
Nominal center conductor diameter	1,63
Nominal diameter over dielectric	7,11
Nominal diameter over first shield (tape)	7,29
Nominal diameter over jacket	10,03
Nominal jacket wall thickness	0,99
Nominal diameter of steel messenger	1,83

**Attenuation (@ 20°C)**

frequency (MHz)	max. loss (dB/100m)
5	1,25
55	3,15
83	3,87
187	5,74
211	6,23
250	6,72
300	7,38
350	7,94
400	8,53
450	9,02
500	9,51
550	9,97
600	10,43
750	11,97
865	13,05
1000	14,27

**Reel parameters**

	width: 360 mm
	flange: 440 mm
	weight: 41 kg
	cable length: 305 m